



## Supercharge your lab or practice with the new 3-Series Versamill AX305DPRO — the ultimate in reliable 24-Hour productivity.

ax305DPRO

The extremely stable construction of the AX305DPRO enables the dry processing of all non-metallic dental materials. With a fully-automatic robotic 8-position blank changer, the system enables versatile machining in 24-hour operation without the problems associated with traditional disc changer systems. 3-Series precision reduces the need for frequent production-robbing machine calibration, while the auto-calibration feature simplifies the process and reduces the time required.

The AX305DPRO is the perfect entry point for labs looking to experience exceptional engineering and craftsmanship. Trusted by some of the biggest names in the industry, the AX305DPRO is known for its low need for calibration and maintenance, ensuring maximum uptime and giving you more time to focus on what matters most—producing high-quality results.

### PURPOSEFUL DESIGN

Designed to be the ideal automated zirconia milling machine, the AX305DPRO will upgrade your productivity while keeping things simple.

With its user-friendly design and features like:

- 8-position auto-loader
- VersaLINK for remote operation, service, & training
- Intelligent tool management to change “end of life” tooling.

You can trust the AX305DPRO to deliver precision and reliability—to perform at it’s best, **every time.**

### INDICATIONS



**SPEED  
COLLECTION**  
SERIES

8-unit disc  
changer

Remote  
Operation

Zero point  
Clamp system

### FLEXIBILITY TO MEET THE DEMANDS OF TODAY AND TOMORROW

Process virtually all current and future dental materials, including: PMMA, Zirconia, PEEK, Pekkton, Hybrid-Ceramic, Sintered Metal, Resins, and More.

Block thickness up to 30mm.



Features like, VersaLINK remote operation and service, tool life management, auto clean, granite machine base, and more provide for precision and reliable production levels.

**ax305DPRO**



Superior dynamic motion and positional accuracy thanks to large-diameter precision ball screws, anti-backlash ball nuts and linear guides with closed loop servo drives.

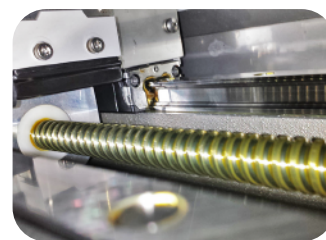

Couple class-leading rotary operating range with granite frame, and Axsys expert machining templates to produce restorations with undercuts, and clean, thin margins.

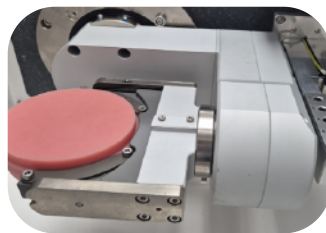

C-Clamp fixture provides unlimited access to critical facial features which produces the highest levels of aesthetics-without the concern of undercuts or typical manufacturing limitations.

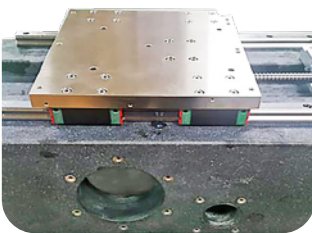

Heavy, stable, granite frame with the lowest coefficient of linear expansion. Provides the rigidity and precision to enable the production of highest possible restoration precision

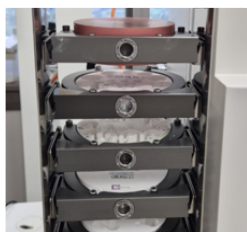

Maximize productivity by overnight and week end operation with class-leading 8-position robotic auto loader.



16-station ATC with automatic tool management and breakage sensor.



Precise assembly and testing of perpendicularity of A-axis and B-axis-vital for accurate multi-axis manufacturing.

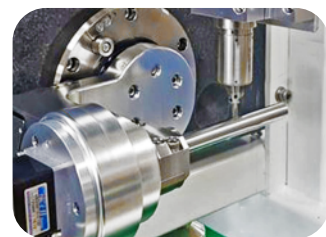

*All Versamill machines come with Axsys' award-winning support and unique software and machine enhancements not available from any other supplier. We leverage over 40 years of digital design and manufacturing experience--spanning a variety of industries--to provide additional functionality, unrivaled reliability and increased productivity.*

## CAM SOFTWARE: PROVEN & FULL-FEATURED

The Versamill **ax208D** is powered by hyperDENT CAM software from FOLLOW-ME! Technology Group.

This software product incorporates efficient, proven milling cycles to provide maximum process stability and indication quality, including patent-protected milling strategies used for complex materials that, coupled with our expert, high efficiency machining templates, ensure perfect surface quality while minimizing cycle time and maximizing tool life.

**hyperDENT**

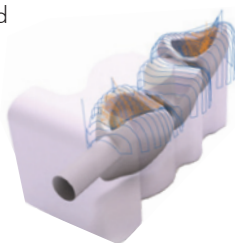

### OPTIONAL MODULES

Full Denture, Hybrid, Implant, Template Generator      Multi Import & Nesting, Implant Bar/Bridge, Expert, Expanded Import

## INCLUDED FIXTURES



### Versamill AX305DPRO Specifications

Number of axes:		5 simultaneous
Travel (x, y, z axis):	(mm)	260mmx100mmx100mm
B Rotational axis:	(degrees)	A-axis: -65°/+245° B-AXIS: -34° /+95°
Processing:		Dry
Drive Mechanism:		Ballscrew
Way System:		Linear Guide
Air Requirement:		6.5 bar
Spindle Power:	(watts)	AC .5 Kw max
Spindle Speed:	(rpm)	100,000
ATC number of tools:	3.0mm Ø	16
Axis Drive System:		Servo Motor w/Encoder
Blank disc diameter:	(mm)	98 Ø
Machine size (W x D x H):	(mm)	752mmx800mmx760mm
Machine size w/Base (W x D x H):	(mm)	752mmx800mmx1700mm
Weight (Machine Only):	(Kg)	145Kg
Input Power	(VAC/50-60HZ)	110-230 /10A Single Phase